

CUBE
REGGICRISTALLO
SUPPORT FOR
GLASS SHELF

 **Perin**
FURNITURE FITTINGS

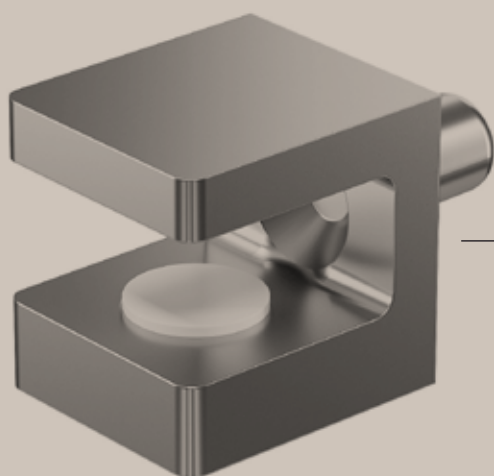

CON PERNO
WITH PIN

SP. 4/6 - 6/8 - 8/10 mm
TH. 4/6 - 6/8 - 8/10 mm

FISSAGGIO A VITE
SCREW FASTENING

SP. 4/6 - 6/8 - 8/10 mm
TH. 4/6 - 6/8 - 8/10 mm

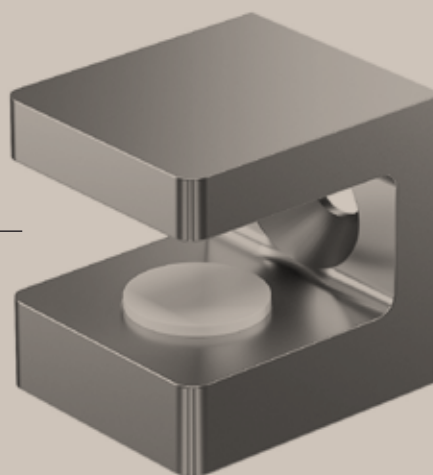

CUBE, il nuovo Reggicristallo della Perin S.p.a., è la risposta ad un mercato che ricerca, anche nei dettagli apparentemente meno importanti, quella coerenza formale che caratterizza nel mondo il mobile italiano.

CUBE, the new support bracket for glass shelves by Perin S.p.a., is designed for users who expect details that are apparently less important to have the same formal consistency that is so characteristic of Italian furniture.

CON PERNO WITH PIN

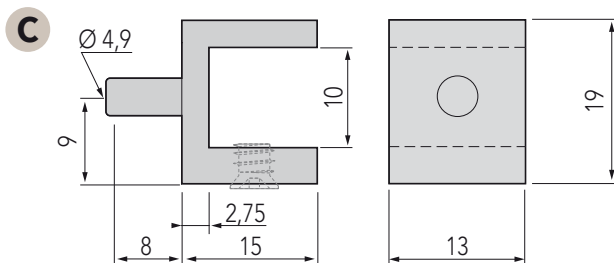
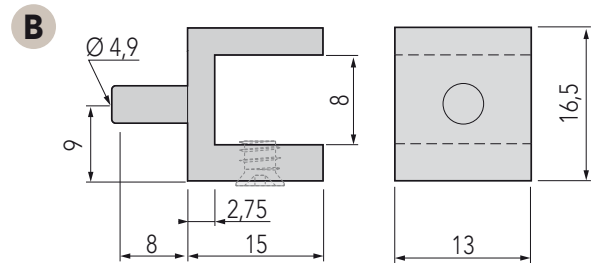
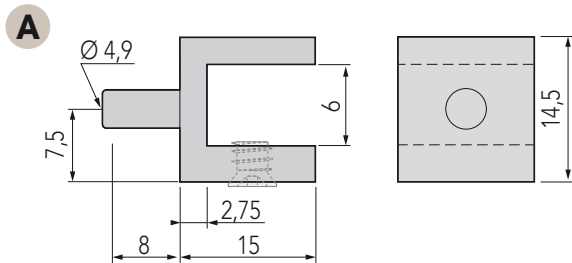
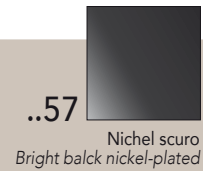

- A** cod. 1053001..
- B** cod. 1053003..
- C** cod. 1053005..

SCHEMA DI MONTAGGIO / ASSEMBLING

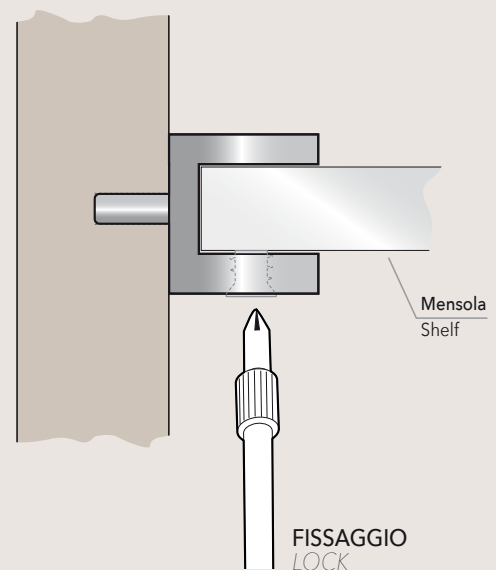
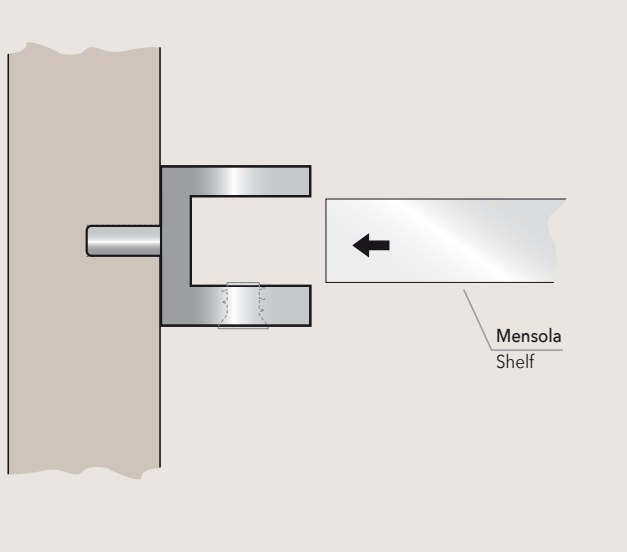

FISSAGGIO A VITE SCREW FASTENING

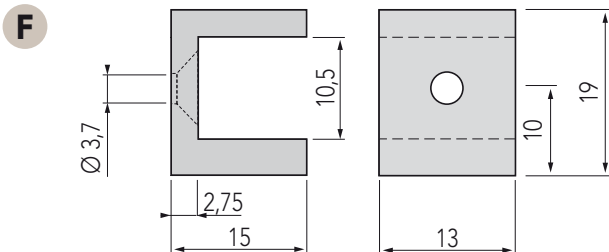
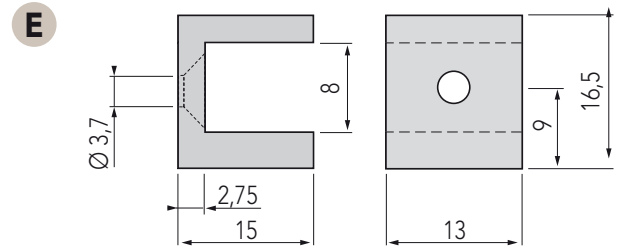
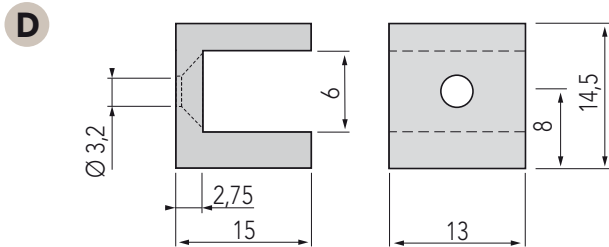
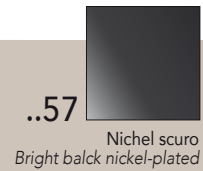

D cod. 1053000..

E cod. 1053002..

F cod. 1053004..

SCHEMA DI MONTAGGIO / ASSEMBLING

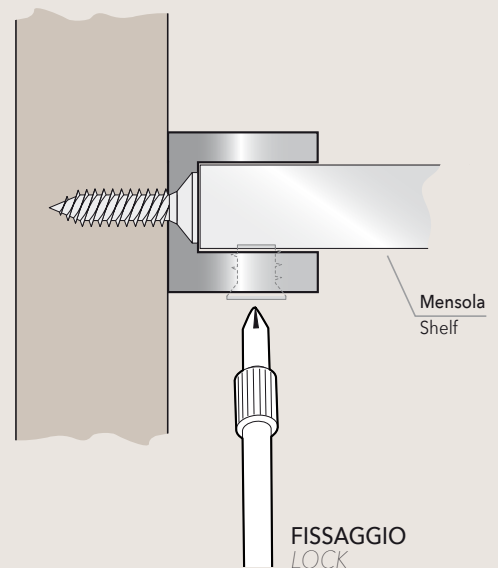
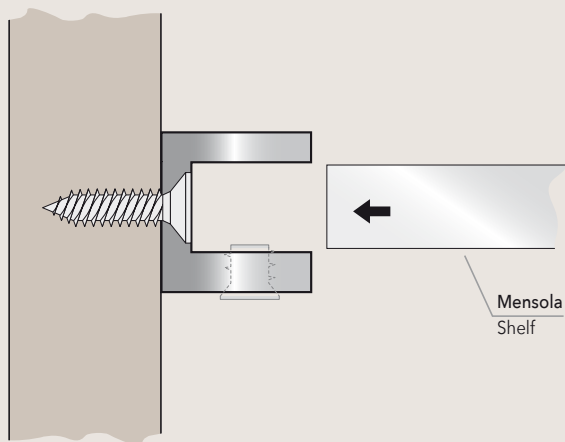



**MADE IN
ITALY**

 **Perin**
FURNITURE FITTINGS

Viale Europa, 30
31018 Albina di Gaiarine (TV) - Italy
Tel. +39 0434 75044 - Fax +39 0434 759190
e-mail: info@perinspa.com
www.perinspa.com